

# W 61806-2Z Deep groove ball bearings

## Deep groove ball bearings

### Bearing data

[Tolerances](#),

Normal (metric), P6, P5, Normal (inch),

[Radial internal clearance](#),

Matched bearing pairs, Stainless steel  
 $d < 10$  mm, Other bearings

### Bearing interfaces

[Seat tolerances for standard conditions](#),

[Tolerances and resultant fits](#)

## Technical specification

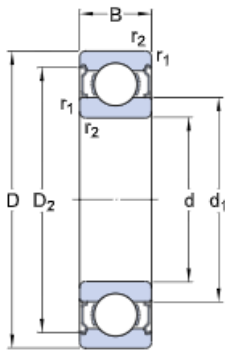

### DIMENSIONS

d	30 mm	Bore diameter
D	42 mm	Outside diameter
B	7 mm	Width
$d_1$	≈ 33.11 mm	Shoulder diameter
$d_2$	≈ 33.11 mm	Recess diameter
$D_2$	≈ 39.2 mm	Recess diameter
$r_{1,2}$	min. 0.3 mm	Chamfer dimension

### ABUTMENT DIMENSIONS

$d_{\varepsilon}$ min.	32 mm	Diameter of shaft abutment
$d_{\varepsilon}$ max.	33 mm	Diameter of shaft abutment
$D_i$ max.	40 mm	Diameter of housing abutment
$r_a$ max.	0.3 mm	Radius of shaft or housing fillet

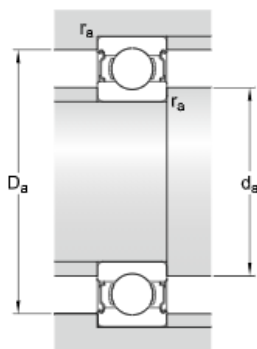

## CALCULATION DATA

C	3.58 kN	Basic dynamic load rating
C <sub>0</sub>	2.9 kN	Basic static load rating
P <sub>u</sub>	0.125 kN	Fatigue load limit
	34 000 r/min	Reference speed
	17 000 r/min	Limiting speed
k <sub>r</sub>	0.02	Minimum load factor
f <sub>0</sub>	14.1	Calculation factor

## MASS

	0.023 kg	Mass bearing
--	----------	--------------

## TOLERANCE CLASS

Normal	Dimensional tolerances
Normal	Radial run-out